

Wearing the Halo Transmitter

Step 1: Pre-adjust the strap to estimate your body size.

Step 2: Firmly snap the transmitter to the strap with the Halo emblem oriented as shown in the figure below.

(Please see the "Wearing the Wireless Transmitter and Chest Strap" section of the myHalo User Guide included with your myHalo System).

Step 3: Wrap around your body and snap the other side.

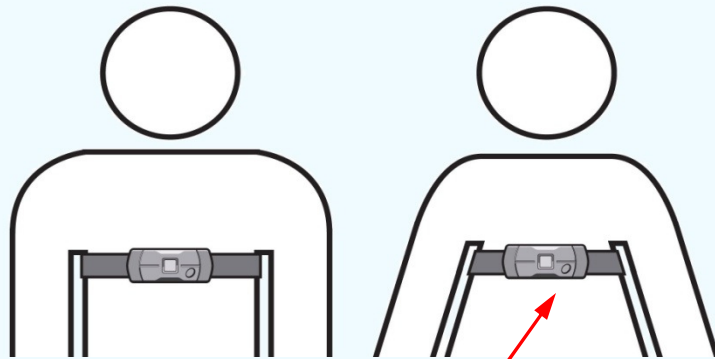

Note the proper location of the Halo emblem.

Step 4: Strap should rest no lower than 2 inches below your sternum.

CAUTION: Failure to keep the strap clean may render the system inoperable. Directions on proper care can be found in the "Frequently Asked Questions" section of the myHalo User Guide. The strap should be cleaned every two weeks or more often at the Users option.

Charging the Battery

Charge the transmitter once a day or as needed.

Step A: Remove the transmitter by twisting the strap at each end.

Step B: Open the battery charger port as shown.

Step C: Plug in and charge for 1 to 1 ½ hours.

Step D: Close the battery charger port and repeat Steps 2, 3, and 4.

Note: The gateway will beep periodically as a reminder that charging is needed.

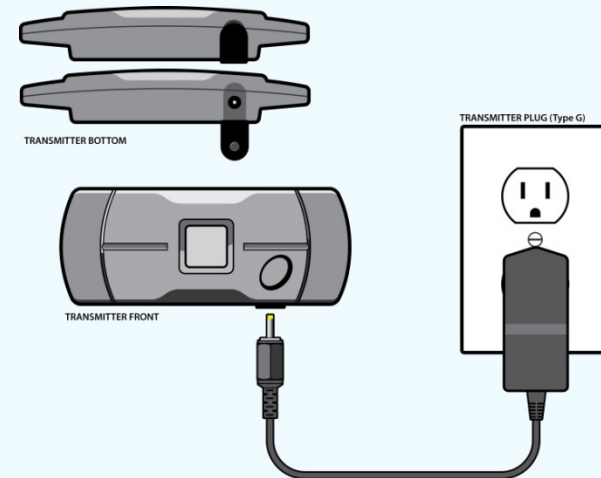

See User Guide for additional information or call
Technical Support: **1-888-971-HALO**

